

# Smart & Sweet Home



## PRODUCT CATALOG



**DURECOM CO., LTD.**

## DURECOM Co., Ltd.

Head Office : 450-2, Mongnae-Dong, Danwon-Gu, Ansan-Si, Gyeonggi-Do, #425-100, R.O. Korea. Tel : +82-31-495-8140, Fax : +82-31-495-8139  
Seoul Office : 5F, 545-7, Dogok-Dong, Gangnam-Gu, Seoul, #135-270, R.O. Korea. Tel : +82-2-2165-2724, Fax : +82-2-3775-3175

[www.durecom.com](http://www.durecom.com)

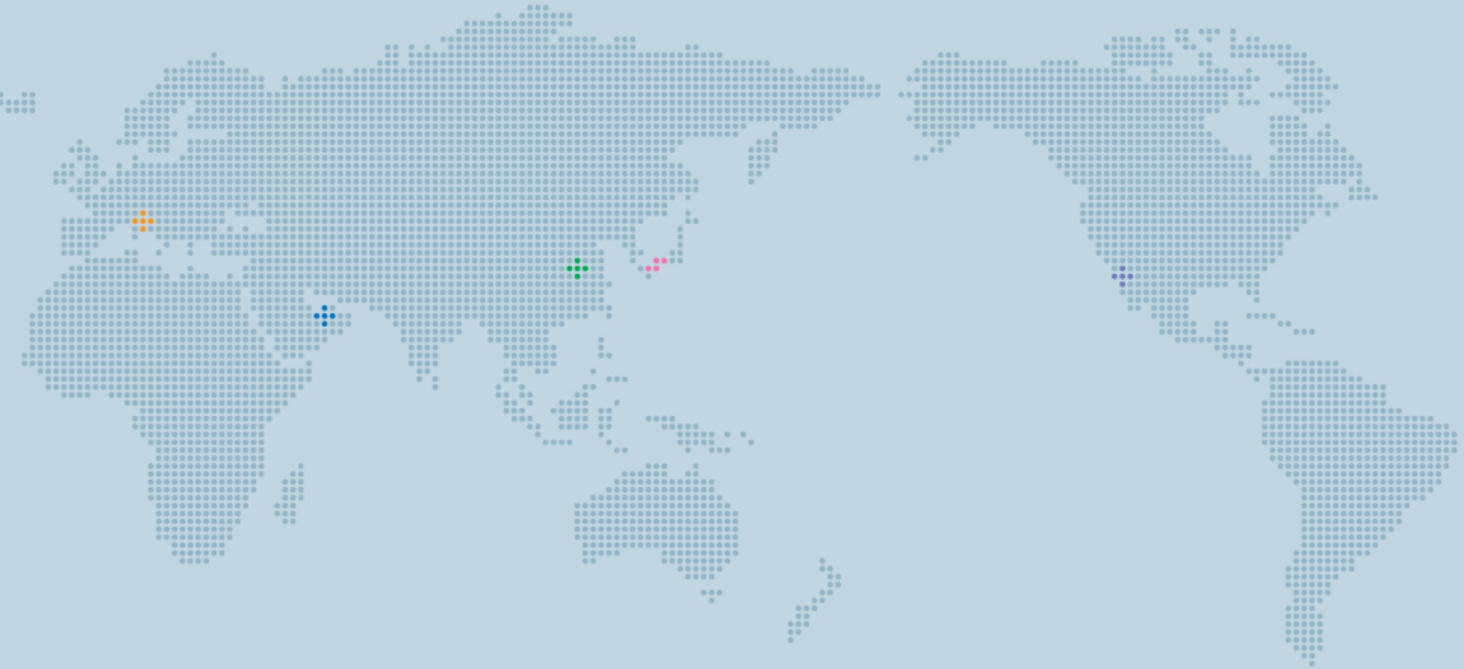



## DIAPHRAGM GAS METER

Gas Type

- City Gas
- L. P. G
- Natural Gas

Features

- DURECOM's gas meter meets the standard of OIML, GOST and EN1359, and WIZIT has gotten domestic pattern approvals which have same quality standard.
- Designed for high accuracy and it has stable performance. It works smoothly and has less pressure loss so it has strong durability.
- Smart and compact for its maximum flow, both left and right inlet make it easy to install the gas meter.
- To use of quality composite materials for smooth rotation of interlocking device makes it possible to measure with accuracy of minimum flow.
- The valve is made of special synthetic resins. So it solves noise problem.
- The drain support is installed so the meter can be maintained safely and there's no possibility to be broken in winter time.
- To use of quality diaphragm, the meter can show stable performance curve.

Material

- Aluminum-die casting body is proven to be solid structure.
- Valve made of graphite-teflon phenol resin minimizes friction and increases wear-resistance and anti-freezing.
- Highly wear-resistant bearings and sturdy transmission part ensure a long trouble-free life.
- Especially rotary parts are sealed tightly with anti-freezing grease.

The principle of operation

- The gas meter works due to the difference of gas pressure between the front and back side of diaphragm. The mechanical loss of gas meter makes drop of the pressure of inflow gas, and it makes the difference of gas pressure between the front and back side of diaphragm.

Performance curve

Drawing of outer feature

Specification of Meter

Division	Model	G 1.6 (KG-2)	G 1.6 (KG-3)	G 2.5	G 4.0
Maximum Flow	m³/h	2.5	2.5	4.0	6.0
Minimum Flow	m³/h	0.016	0.016	0.025	0.040
Cyclic Volume	L/rev	0.4	0.78	1.0	1.2
Normal Working Pressure	kpa	10	10	10	10
Register Capacity	m³/h	9,999	9,999	99,999	99,999
Minimum Graduation	L	0.2	0.2	0.2	0.2
Net Weight / With Accessories	Kg	1.2 / 1.47	1.6 / 1.88	1.8 / 2.0	2.0 / 2.3
	Height (H)	197	214	221	230.5
	Width (W)	128	164	164	165
	Center (C)	100	130	130	130
	Depth (D1)	44	52	55	55.2
	Depth (D2)	110	130	134	134.5
Performance (%)	Q min ≤ Q < 0.1Qmax	± 3.0	± 3.0	± 3.0	± 3.0
	0.1Qmax ≤ Q ≤ Qmax	± 1.5	± 1.5	± 1.5	± 1.5
Using Temperature		-20 ~ +60	-20 ~ +60	-20 ~ +60	-20 ~ +60
Connection Tube		15mm (PT 1/2)	20mm (PT 3/4)	20mm (PT 3/4)	20mm (PT 3/4)

## REMOTE TYPE GAS METER

### Features / Construction

#### Features

- Accurate inspection is possible at the remote location, due to the built in electric signal output (Pulse Output).
- Easy to set up and remove regardless of the place.
- Be convenient for control because it doesn't need a outside sources of electricity.



#### Construction

##### Body

The built in pulse output(magnet, Reed s/w) transmits the date of flow.

##### Display Panel

By using a microprocessor and LCD, the cumulative effect of flow is displayed on the indicating panel from the body.

### The principle of operation

- The built in pulse output makes electric signal after mechanical measure(100) of the gas flows and it transmits the date to the indicating panel.

### Material / Use

- Aluminum-die casting body is proven to be solid structure.
- Valve made of graphite-Teflon phenol resin minimizes friction and increases wear-resistance and anti-freezing.
- Especially rotary parts are sealed tightly with anti-freezing grease.
- The telecommunication module is installed in the meter, it is possible to be connected with various type of AMR system.

### Connection Tube & Nut

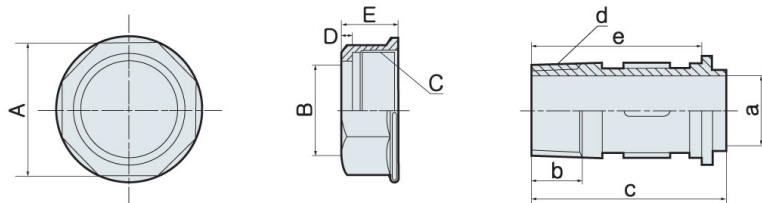

MODEL	NUT(mm)					TUBE(mm)				
	A	B	C	D	E	a	b	c	d	e
G1.6 (KG-2)	30	Ø21	Ø25 18Thread's/Inch	3.0	16	Ø14	18	50	15 mm PT1/2"	44
G1.6 (KG-3S)										
G1.6 (KG-3)	37	Ø28	M34 x 1.5	3.0	16	Ø20	15	55	20mm PT3/4"	48
G2.5										
G4.0										

## GAS METER FOR WIRELESS METER READING

### Features

- Designed for extremely economize in power (25uA normal operation current), it guarantees more than 5 years life.
- Be Semi-permanent because of using MR sensor.
- Be secure against on account of broken wires due to the built in pulse sensor.
- A Gas meter and a wireless terminal are united so anything is needed for installation.
- The problem by raindrops is not happened because the gas meter is constructed by watertight form.
- Be Possible to connect with RS-485 and 232.
- Re-transmit when the repeater didn't receive the date.



### Specification

CPU :: 8bit Micro controller

Memory

- RAM [1K bytes]
- ROM [Flash(Program/Data)16K world] , Backup Memory [32Kbytes]

UHF RF

- GFSK [424MHz] , Data rate : 250Kbps [Max 1Mbps]

Meter Interface :: [MR Sensor]

Protocol Topology :: WARPII(Complexed Ladder Network)

### Use

- DIAPHRAGM GAS METER FOR WIRELESS AMR SYSTEM is not needed any inspector and it is possible to manage the data of the used amount at the center without line.